



# INSTALLATION MANUAL



## Table of Contents

---

1. INTRODUCTION .....	2
2. RECOMMENDATIONS .....	2
3. DAB MODULE CONNECTION DIAGRAM .....	4
4. LOCATION OF KIT COMPONENTS .....	5
5. LOCATION AND CONNECTION OF THE MODULE .....	5
6. ANTENNA CONNECTION .....	6
7. BASIC TECHNICAL PARAMETERS .....	7
8. SET OF COMPONENTS .....	7

# 1. Introduction

---

Digital radio tuner DAB/DAB+ for factory car radio VW/SKODA/SEAT/AUDI. Module JRDAB-04 allow to receive and play digital radio stations on factory sound system. Device has function which allow to follow selected station while riding. Full integrated with CAN bus system.

## 2. Recommendations

---

### Copyright

All assembly and operating instructions are protected by copyright. Distributing documentation via print or online media is only allowed with the prior consent of JUNA electronics.

### Important

Please read installation manual very careful and keep it in right way. During installation, pay attention to all relevant aspects related to safety of installation and use of the device.

The priority during the design and production of all devices by JUNA electronics company is security and service comfort. It has been achieved by applying the modern techniques of design and production processes of electronic devices.

Module should be installed in technical workshops by qualified personnel or by people who have experience in this type of installations. Installation of devices by not qualification people can cause injury to persons or damage to property.

It is recommended keep to the general safety rules and pay attention for any threat that can cause of damage to the vehicle.

We advice to mount device in safety place, where it is not exposed for moisture, water or too high temperatures.

## 2.1. Recommendations

---

Device should not be installed in places where it could difficult safe driving or operating efficiency of other units installed in vehicle.

The devices can be connected only to 12V. Modules can't be used in vehicles with 24V and higher voltage.

Please note that most of our devices are based on software that may require an update. That's why you should always mount the device in easily available place in the vehicle.

In some countries it may be necessary to check the legal provisions before installation and startup of the device. In the interest of high quality and development of our products, JUNA Electronics reserves the right to make technical changes.

In the case of a warranty claim, the device should be sent back to the seller in original packaging with a detailed description of the problem with attached purchase invoice.

Warranty claims as well as exploitation rights expire due:

- A) Not authorized changes in devices or accessories, which have not been approved or have not been provided by the manufacturer or his partners.
- B) Opening the device's box
- C) Yourself repair the device
- D) Improper use / improper operation of the device
- E) Mechanical damage
- F) Flooding with water or other liquids

### 3. DAB/DAB+ module connection diagram

1. Turn off the ignition and car radio
2. Disconnect the factory ISO connector from the MIB module **1**
3. Connect the supplied ISO plug of the W-JRDAB-04-101 harness to the ISO connector MIB radio unit **2**
4. Connect the factory ISO connector to the W-JRDAB-04-101 ISO harness socket **3**
5. Disconnect the LVDS cable from the radio unit **4**
6. Connect the LVDS cable from the set to the radio unit and the JRDAB-04 module **5**
7. Connect the factory LVDS cable of the screen to the JRDAB-04 module **6**
8. Connect the 18-pin W-JRDAB-04-101 harness connector to the JRDAB-04 module **8**
7. Connect the antenna to the JRDAB-04 module (Fakra connector) **9**
8. Switch on the ignition and start the DAB radio by selecting the AUX source with the MEDIA button

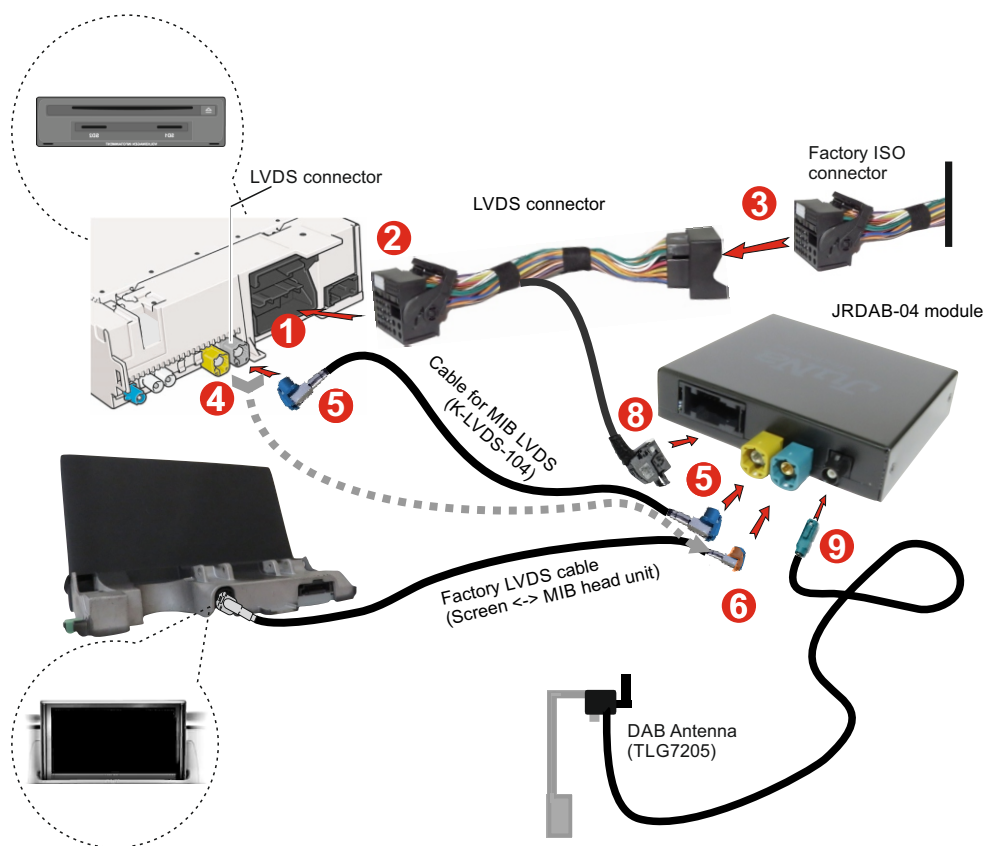

#### CAUTION:

The JRDAB-04 module is set by default in the resolution of 800x480. To change screen resolution 1024x480 should be pressed 3 times within 3 seconds button **10** on the JRDAB-04 module housing

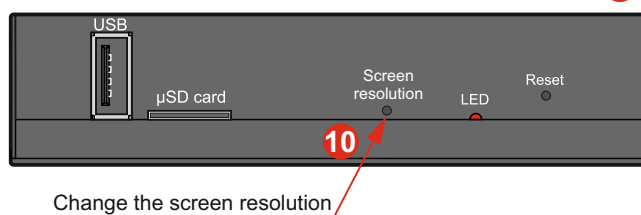



## 4. Location of kit components

1. JRDAB-04 module installation place behind the car glove box
2. DAB/DAB+ antenna installation location

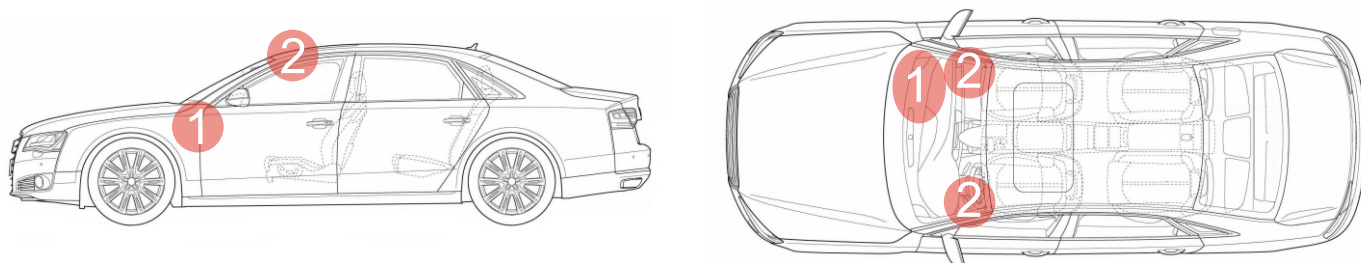

## 5. Location and connection of the module

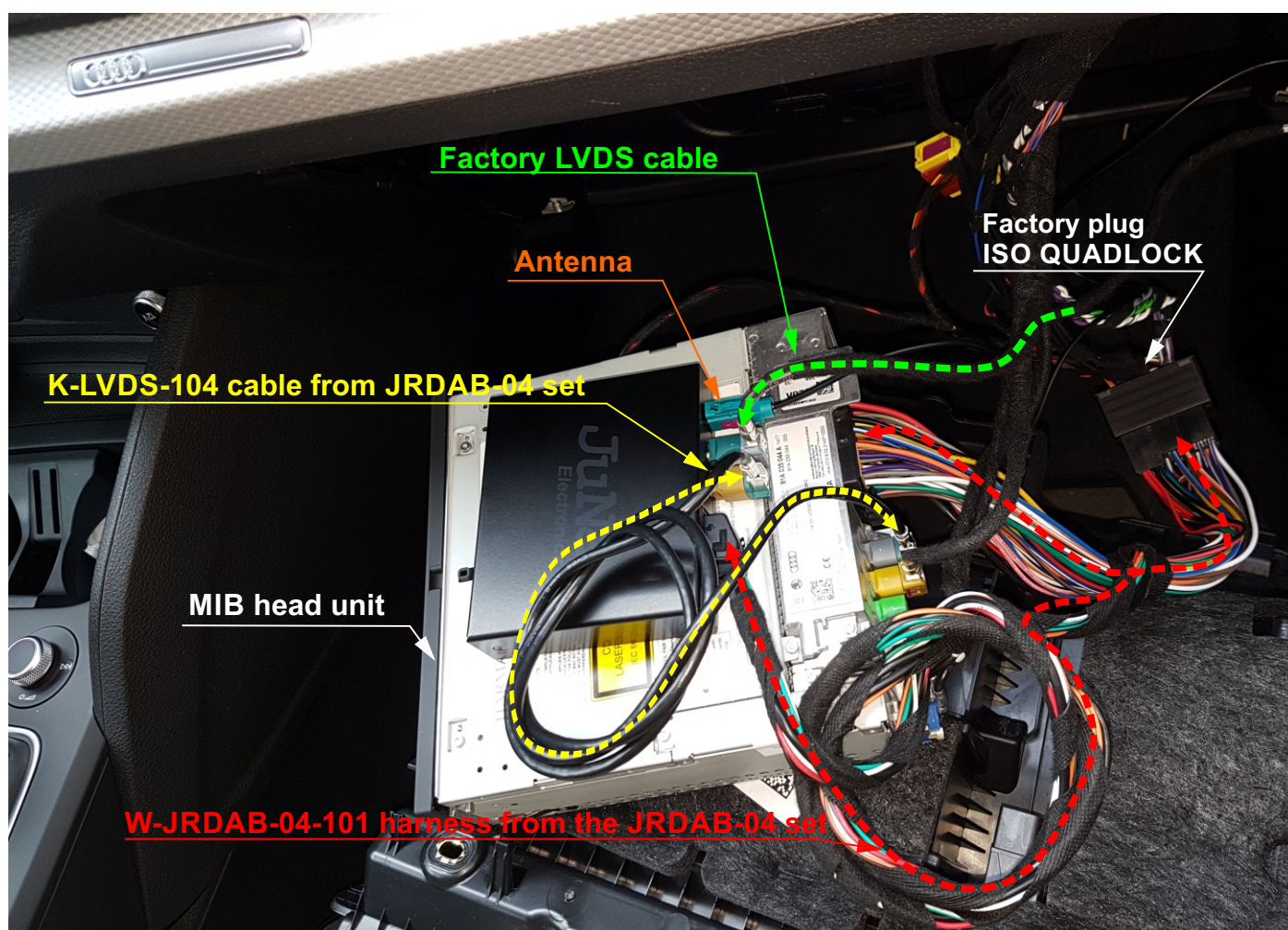

## 6. Antenna connection

The device in addition to the possibility of connecting the DAB/DAB+ antenna included in the set, allow to connect the factory antenna set which includes the factory antenna with the antenna amplifier mounted most often on the tailgate of the luggage compartment. The amplifier is powered from the JRDAB-04 module with 8,2V or 12V max 150mA.

### Important:

During installation antenna cable along the pistol it is necessary to pay attention for side airbags. Cable must be installed in way to not disturb the proper operation of the air curtain.

### Installation process:

- 1) Installation of antenna is not recommended when windscreen is very cold
- 2) Antenna should be mounted on windscreen from passenger side
- 3) Carefully remove the passenger side pistol cover
- 4) Clean a place where antenna will be mounted
- 5) Antenna should be mounted 15 cm from top edge and 7 cm from side edge of windscreen
- 6) Ground element of antenna amplifier should touch metal part of post. It can be join to factory painted part of pistol
- 7) Antenna cable should be mounted in way to not interference with side airbag

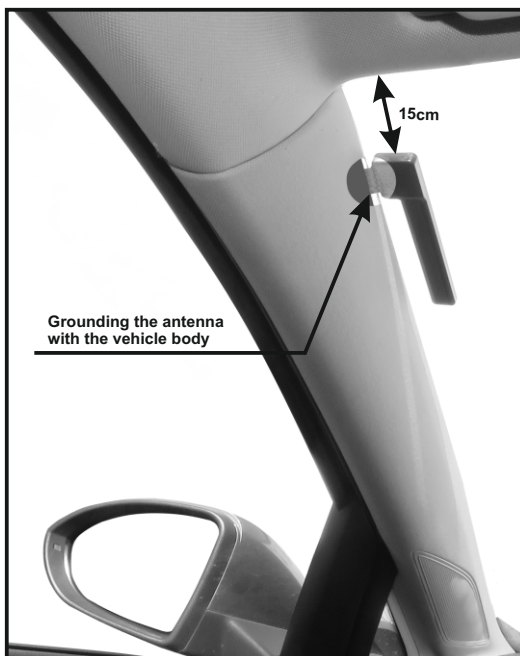

Example of mounting a DAB/DAB+ antenna

Before antenna installation on windscreen remove top safety cover.



To join a metal ground component of antenna amplifier remove top safety cover. Join copper ground component with metal part of cars body.



Antenna DAB/DAB+

## 9. Basic technical parameters

1. Supply voltage	- 12V
2. Active power consumption with antenna	- 321mA
3. Active power consumption without antenna	- 281mA
4. Standby current	- 0,039mA
5. Antenna Power (Phantom System)	- 8,2V or 12V (max 150mA)
5. Communication and control	- CAN
6. Housing	- Metal
7. Dimensions	- 107,2mm x 92,6mm x 25,2mm
8. Weight	- 280g

## 10. Elements set

